



Seattle Distribution Center

6729 E MARGINAL WAY S, SEATTLE, WA

FOR LEASE



17 MINS
Seattle CBD

For Leasing
Information Contact

EVAN LUGAR
206.248.6505
evan.lugar@kidder.com

PATRICIA LOVEALL, SIOR
206.248.7340
patricia.loveall@kidder.com

SeattleDistributionCenter.com

**Kidder
Mathews**

OWNED
BY

CLARION PARTNERS

This information supplied herein is from sources we deem reliable. It is provided without any representation, warranty, or guarantee, expressed or implied as to its accuracy. Prospective Buyer or Tenant should conduct an independent investigation and verification of all matters deemed to be material, including, but not limited to, statements of income and expenses. Consult your attorney, accountant, or other professional advisor.

KIDDER.COM

FOR LEASE

Seattle Distribution Center

6729 E MARGINAL WAY S, SEATTLE, WA

Floor Plans

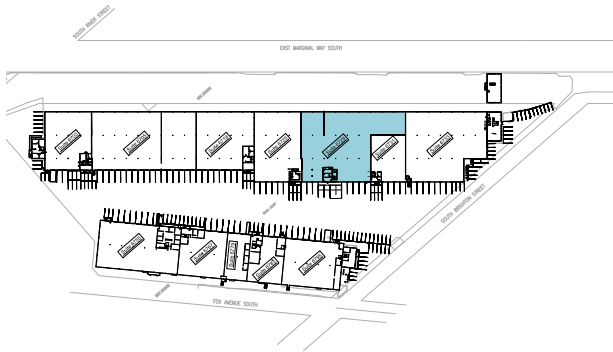
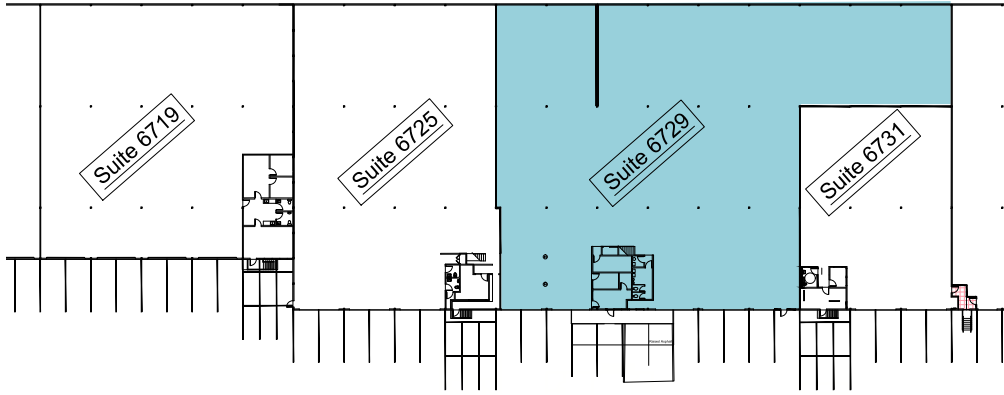

SUITE 6729
24,274 SF TOTAL WITH 793 SF OFFICE

24,274 SF total; 793 SF office

Ceilings: 26'

9 dock high loading positions (2 oversized docks)

Column spacing: 24' x 48'

Construction type: concrete tilt-up (1967)

Zoning: IG1/U-85

Seismic: building upgraded to current code in 2005

See attached plan for office/warehouse configuration

Call for rates

EVAN LUGAR
206.248.6505
evan.lugar@kidder.com

PATRICIA LOVEALL, SIOR
206.248.7340
patricia.loveall@kidder.com

KIDDER.COM

This information supplied herein is from sources we deem reliable. It is provided without any representation, warranty, or guarantee, expressed or implied as to its accuracy. Prospective Buyer or Tenant should conduct an independent investigation and verification of all matters deemed to be material, including, but not limited to, statements of income and expenses. Consult your attorney, accountant, or other professional advisor.

