



CLARION PARTNERS

For Lease



Seattle Distribution Center

6795 E Marginal Way S
Seattle, WA

12,838 Square Feet Available



BUILDING HIGHLIGHTS

- 12,838 SF available
- 2,054 SF office
- 24' clear height
- 4 dock high doors (1 with ramp)
- Endcap space
- Column spacing 24' x 48'
- Concrete tilt-up construction (1967)
- Zoned IG1/U-85
- Seismic building upgraded to current code in 2005
- Available January 1, 2021
- Call for rates



This information contained herein was obtained from sources deemed reliable and is believed to be true. It has not been verified and as such, cannot be warranted nor form any part of any future contract.



CLARION PARTNERS

Seattle Distribution Center

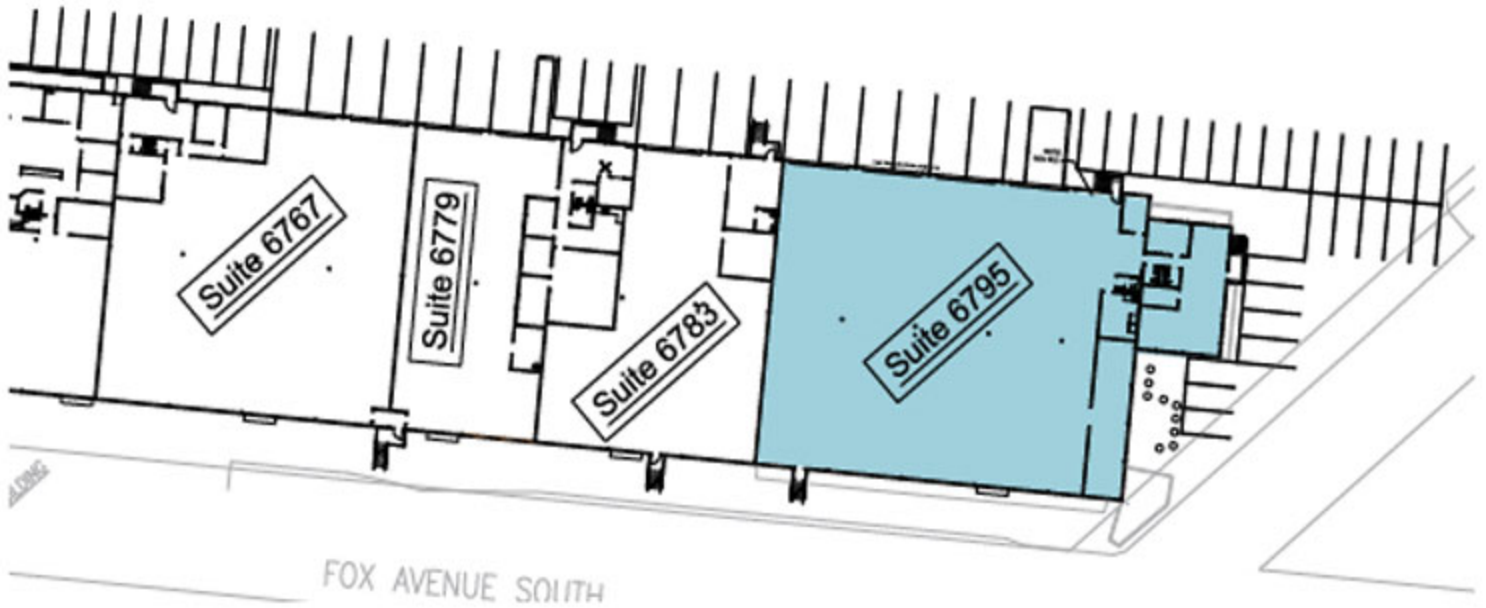

CLARION PARTNERS

www.clarionpartners.com

For more information on this opportunity, please contact



Evan Lugar
206.248.6505

evan.lugar@kidder.com

Patricia J. Loveall
206.248.7340

patricia.loveall@kidder.com